

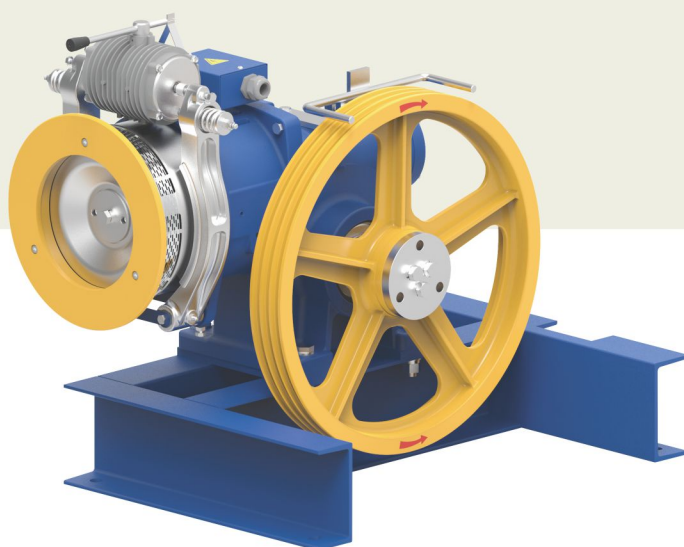

GEARED TRACTION MACHINE

Stellar
125



Static Load (kg)
3000



Gear Ratio
1/41



Brake Voltage (DC)
110V, 220V



Oil Capacity (Ltr)
2.0



Weight of Machine (kg)
204* (With Bed Plate)*

* Weight of machine is varies according to selection of sheave, Motor & Drive system.

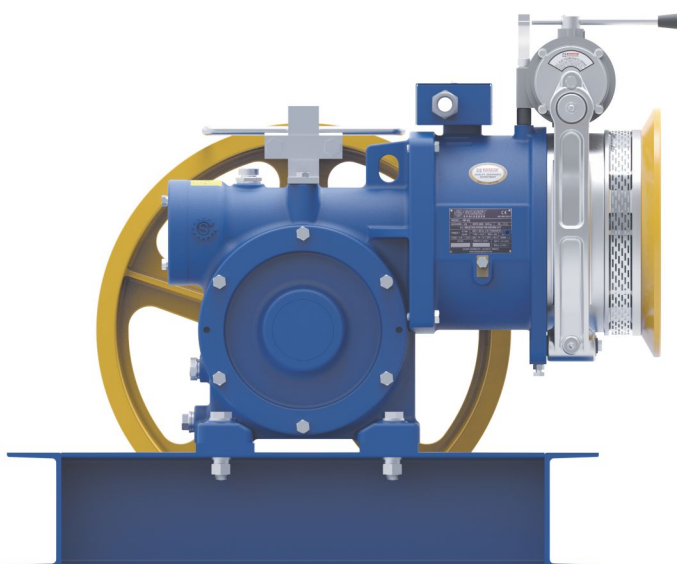

GEARED

TRACTION MACHINE

Stellar
125

Listed loads don't include the rope's weight.
In order to know the net loads capacity, subtract rope's weight from the listed loads.

Position of the gearbox Up
Counter weight 50%
Plant efficiency 0.80

AC VVVF

400 V

50 Hz

Travelling : - 30 mtr

Machine	Duty Load		Roping	Async. Speed	Ratio	Motor Detail		RPM	Rated Current	Sheave Specification
	Person	Kg		(m/sec)		(kw)	(HP)			Sheave Dia x Rope Dia. X No. of Groove
STELLAR - 125	6	408	1:1	0.70	1/41	3.7	5.0	930	8.8	Ø 530 X 13mm X 3 Grv.
				1.00	1/41	4.5	6.0	1430	9.2	Ø 530 X 13mm X 3 Grv.
STELLAR - 125-R1	8	544	1:1	1.00	1/41	5.5	7.5	1455	11.5	Ø 530 X 13mm X 3 Grv.

Kindly contact us for various speed and load combination

Machine	Duty Load	A	B
Stellar-125	408 Kg	870	715
Stellar-125 R1	544 Kg	910	725

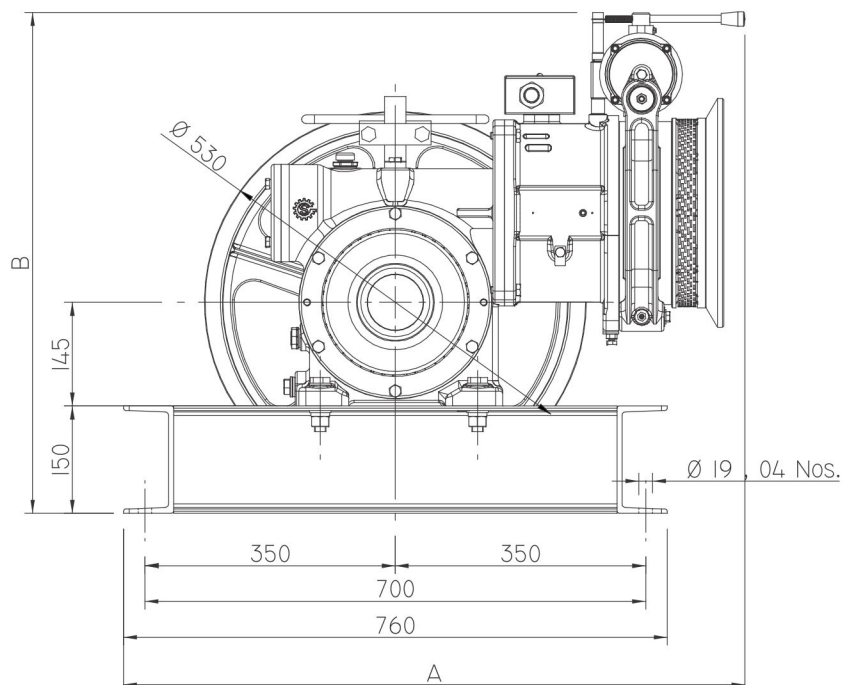

Subject to change without any prior notice!

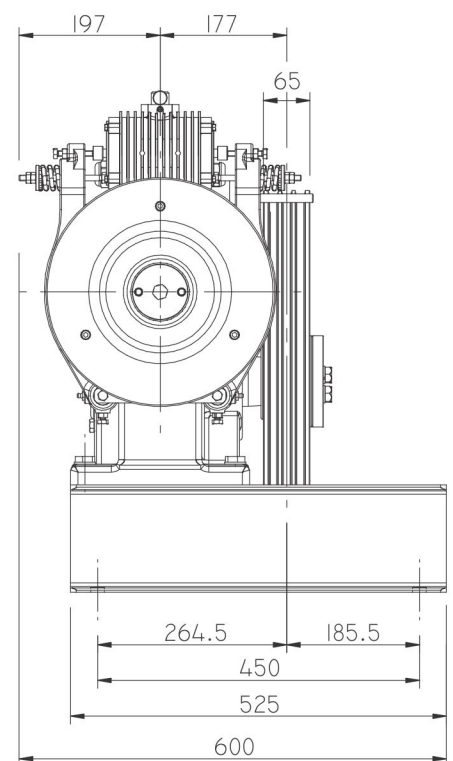

(All dimensions are in mm)