

**Static Load (kg)**  
3200



**Gear Ratio**  
1/45



**Brake Voltage (DC)**  
110V, 220V



**Oil Capacity (Ltr)**  
3.5



**Weight of Machine (kg)**  
283\* (With Bed Plate)\*

\* Weight of machine is varies according to selection of sheave, Motor.

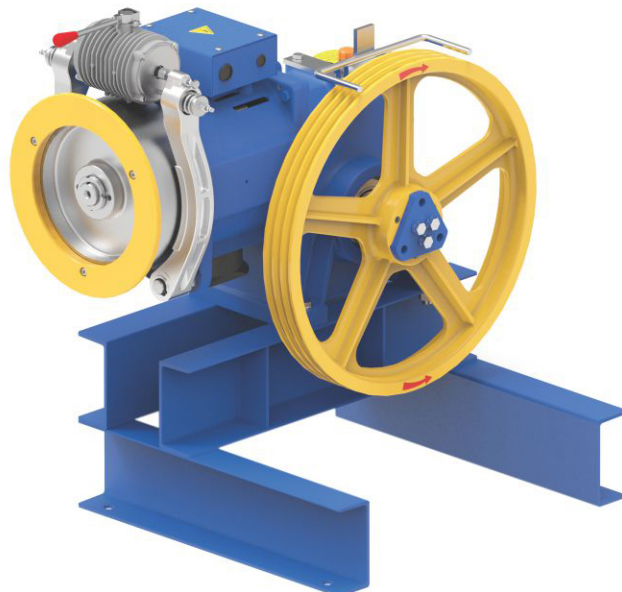

# Geared Traction Machine



Listed loads don't include the rope's weight.  
In order to know the net loads capacity, subtract rope's weight from the listed loads.

Position of the gearbox                      Up  
Counter weight                                      50%  
Plant efficiency                                      0.80

AC VVVF    400 V    50 Hz    Travelling : - 30 mtr

| Machine | Duty Load |     | Roping | Async. Speed | Ratio | Motor Detail |      | RPM      | Rated Current | Sheave Specification                   |
|---------|-----------|-----|--------|--------------|-------|--------------|------|----------|---------------|--|
|         | Person    | Kg  |        | (m/sec)      |       | (kw)         | (HP) | (Async.) | (A)           | Sheave Dia x Rope Dia. X No. of Groove |
| TOTUS   | 10        | 680 | 1:1    | 1.00         | 1/45  | 7.5          | 10.0 | 1423     | 14.5          | Ø 560 X 13mm X 4 Grv.                  |
|         | 1000      |     | 2:1    | 0.50         | 1/45  | 5.5          | 7.5  | 1455     | 11.5          | Ø 560 X 13mm X 3 Grv.                  |

| Ø P  | N X Ød  | A  | B   | C   | D   |
|------|---------|----|-----|-----|-----|
| Ø560 | 3 X Ø13 | 65 | 184 | 264 | 236 |
| Ø560 | 4 X Ø13 | 92 | 193 | 273 | 227 |

Kindly contact us for various speed and load combination

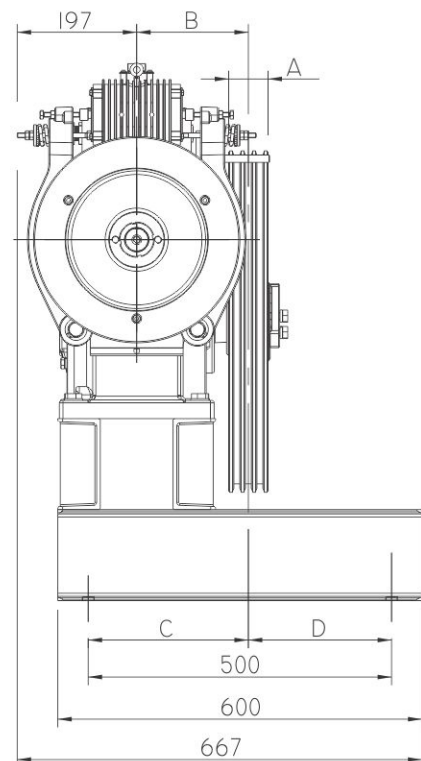
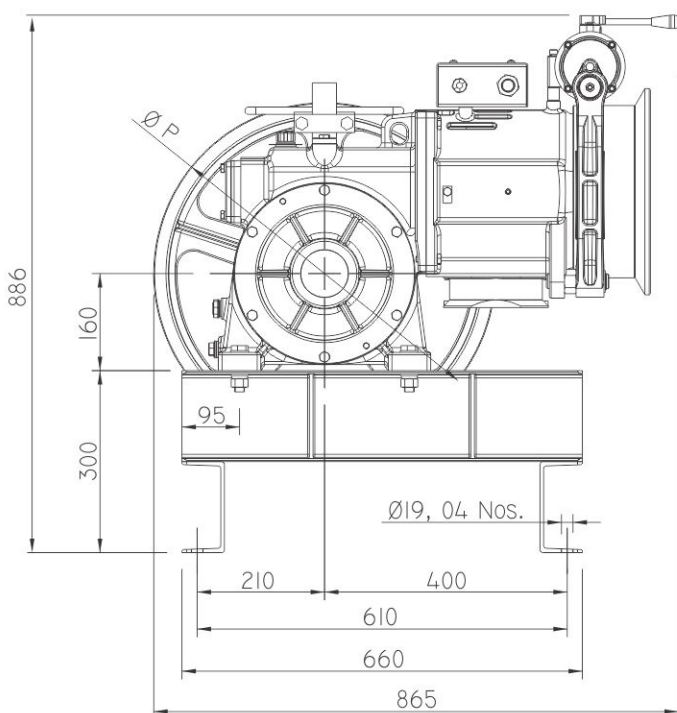

(All dimensions are in mm)